

MODULAR DUO-DYNAMIC FLOAT (MDF) TECHNOLOGY

APPLICATIONS: Medium to large varying load demands, including mainline drips, header drips, air-handling equipment, process equipment

BENEFITS:

- Quick expulsion of air / non-condensables at start-up and throughout operation
- Fast-acting with continuous and complete discharge of condensate for efficient thermal transfer & dry steam
- Simple design for quick & easy proactive maintenance
- No failing thermal elements and no priming necessary
- No need for replacement parts or inventory
- Protection against water-hammer shock
- Consistently accurate operation with a heavy-duty free float that self-aligns to same contact point, which is a durable disc that will not dent or deform



PRODUCT OF THE U.S.A. • PAT. PENDING

SPECIFICATIONS:

TOP

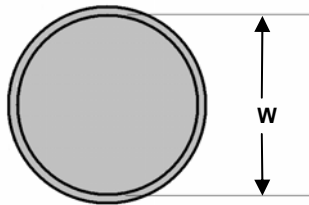

SIDE VIEW

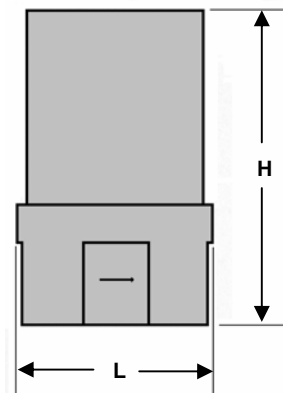

Model Size	Dimensions in Inches (mm)		
	H	L	W
MDF-L 3/4" (NPT)	3.500 (89)	2.185 (55)	2.065 (52)
MDF-M 3/4" (NPT)	5.000 (127)	3.250 (83)	2.875 (73)

Part	Material
1 Base	Stainless Steel
2 Cover	Stainless Steel
3 Port Seat* & Guide Pin	Stainless Steel
4 Float	Stainless Steel
5 Contact Disc	Stainless Steel
6 Secondary Strainer	40 Mesh Stainless Steel
7 Support Spring	Stainless Steel
8 Hammerguard	Stainless Steel
9 Ring Gasket	Gylon / Garlock

Maximum Operating Conditions	
Pressure	125 psig (8.5 bar)
Temperature	500°F (260°C)

SIDE VIEW (EXPLODED)

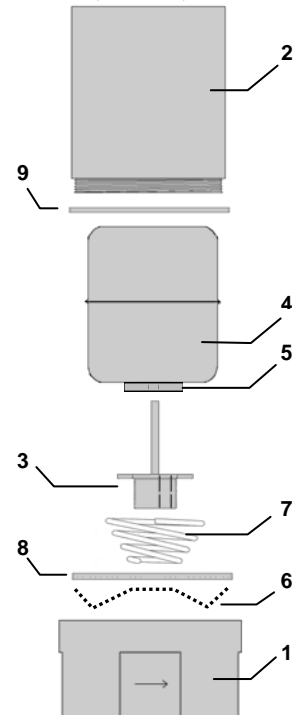

*NOTE: TECH-FITT® engineers specify appropriate port seat for each application.

DESCRIPTION:

MDF systems shall have a base, cover, vertically moving free float with reinforced contact disc, port seat, and an optional secondary strainer of stainless steel 40 mesh with a minimum diameter of 1.5" or 2.0" (MDF-L & MDF-M respectively). Float shall be guided by a stainless steel pin for accurate seal. Port seat will secure strainer, support spring and hammerguard by inserting into base. All parts, except gasket, shall be manufactured from 300 Series Stainless Steel and will not wear out with usage.

All parts shall be interchangeable with any other MDF system of the same model. This modular design facilitates proactive maintenance & is quickly adaptable to changes without removing assembly from piping. All port seats are specified by TECH-FITT® engineers to match load capacities needed (within prescribed efficiency parameters) for each trap application. Refer to installation instructions for proper configurations & other guidelines.

*Drawings are not to scale and dimensions are approximate.
 Information provided (including materials, dimensions, and availability) is subject to change without notice.*