



6130 Southwest Avenue ♦ St. Louis, MO 63139 USA
 TEL: 314.644.5988 ♦ FAX: 314.644.6788

MODULAR LABYRINTHINE ENGINEERING SPECIFICATIONS

STEAM TRAP MODEL: STL / STH / SDD

MODULAR LABYRINTHINE TECHNOLOGY

APPLICATIONS: Constant to small varying load demands and equipment with regulated loads.

BENEFITS:

- Efficient, consistent, economical operation
- No failing thermal elements or need for replacement parts
- Simple design for quick & easy proactive maintenance
- Optimum control against energy losses & maintenance costs
- Modular design is adaptable to changes without breaking pipe



PRODUCT OF THE U.S.A. • U.S. PAT. #6,148,844

SPECIFICATIONS:

Model Size	Dimensions in Inches (mm)		
	H	L	W
STL / STH 3/4" (NPT)	3.500 (89)	2.185 (55)	2.065 (52)
STL / STH / SDD 1" (NPT)	5.000 (127)	3.250 (83)	2.875 (73)

TOP VIEW

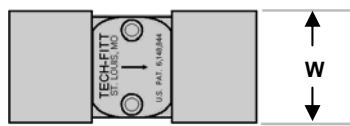

SIDE VIEW

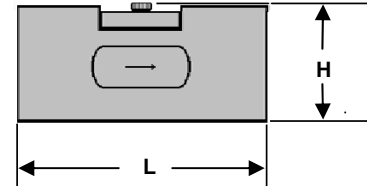

Part	Material
1 Body	Stainless Steel
2 Cover	Stainless Steel
3 Cap Screws (2)	Stainless Steel
4 Trapping Module*	Stainless Steel
5 Disc (SDD model)	Stainless Steel
6 Secondary Strainer	40 Mesh Stainless Steel
7 Gasket	Garlock

SIDE VIEW (EXPLODED)

STL / STH

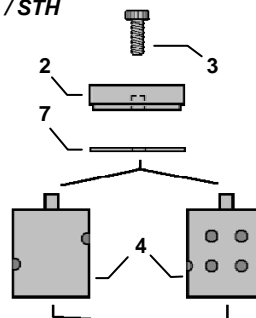

SDD

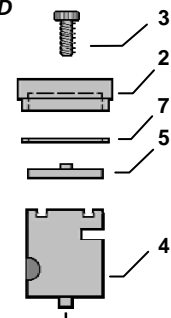

Maximum Operating Conditions	
Pressure	125 psig (8.5 bar)
Temperature	500°F (260°C)

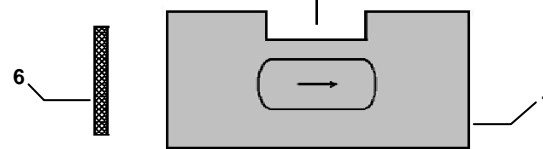

*NOTE: TECH-FITT® engineers specify appropriate trapping module for each application from over 150 different model numbers.

DESCRIPTION:

Modular Labyrinthine systems shall have a body, removable cover held in place by two (2) cap screws, trapping module, disc (SDD model only), and secondary screen of stainless steel 40 mesh with a minimum diameter of one (1) inch. All parts, except gasket, shall be manufactured from 300 Series Stainless Steel and will not wear out with usage. These systems are provided with an appropriate mesh Y-strainer and blow-down valve.

All parts shall be interchangeable with any other Modular Labyrinthine system of the same size. This modular design facilitates proactive maintenance & is quickly adaptable to changes without removing assembly from piping. TECH-FITT® engineers select from a variety of trapping modules to match load capacities needed (within prescribed efficiency parameters) for each trap application. Refer to installation instructions for proper configurations & other guidelines.

*Drawings are not to scale and dimensions are approximate.
 Information provided (including materials, dimensions, and availability) is subject to change without notice.*